



KING BABY

KING BABY

KING BABY is a 140-foot (42.7m) chic, sexy luxury yacht influenced by rock 'n' roll and the jewelry line King Baby.

Both the exterior and interior were designed by the renowned Evan K. Marshall, who used the aesthetic themes to create a lusciously contemporary luxury yacht. This tri-deck yacht is both tall and beamy with a 4 fin "At Rest" stabilizer system making KING BABY extremely stable at anchor and underway. Her exterior spaces are expansive and well suited for entertaining and socializing. The main deck aft has a covered dining area; as does the upper deck, with a variety of seating spaces. This area is air conditioned as well. Forward on the upper deck is built-in seating and sunpads. The sundeck has a Jacuzzi with a three-tier cascading waterfall and swim-up bar, a variety of seating areas, three TVs and a large onyx bar.

The sexy rock 'n' roll-inspired interior is unlike that on any other yacht. From Keith Richards' doors to custom coffee tables to vintage hood ornaments, guitars used as art and other impressive decorative pieces, there is so much to behold. The alluring indoor spaces are comfortable, with an edge of modern seduction. The owners spent months curating classic rock photography, which is showcased throughout the yacht. The ideal charter yacht for groups of friends ready to let the good times roll, this yacht has both sass and style.

KING BABY has 5 luxurious staterooms. The main deck is home to the large full-beam master with a steamy his-and-hers en-suite bathroom with both a bathtub and shower. Three large king staterooms below deck all have en-suite bathrooms. There is also a spacious twin cabin below deck.

KING BABY is both inviting and provoking. Thanks to her stellar onboard atmosphere, you may walk on the yacht, but you'll strut when you leave... always wanting more.





Specifications

Cabin Config.	1 Master, 3 Double, 1 Twin
Length	140 ft
Beam	31 ft
Draft	8 ft
Displacement	270 tons
Gross Tonnage	497 ITC
Built	2016
Construction	GRP
Engines	2 x MTU 2600hp
Cruising speed	15 Knots
Builder	IAG Yachts
Ext. designer	Evan K Marshall
Int. designer	Evan K Marshall

Tender + Toys

- ▶ 39ft 2018 Nortech 390 with triple Mercury Verado 350hp engines. Dayhead.
- ▶ 16.5 ft Williams Jet Tender
- ▶ 2 2016 Yamaha Wave Runners
- ▶ Sensational waterslide from sun deck
- ▶ 2 SeaBobs
- ▶ Zapata Flyboard
- ▶ 4 Paddle boards
- ▶ 2 x sets of kite gear
- ▶ 2 Inflatable Kayaks, Wakeboard
- ▶ Kneeboard, Water Skis
- ▶ Towable Tube
- ▶ Snorkel gear (masks and fins)
- ▶ Light fishing gear, Spearfishing gear
- ▶ Various Beach Toys

Main Salon



Main Salon



Main Salon



Dining Salon



Main Aft Deck





Main Foyer



Master Stateroom Entry



Master Stateroom



Master Bath



Master Bath



Upper Level Stairwell



Skylounge



Skylounge



Skylounge



Upper Deck Dining



Upper Deck Dining







Upper Aft Deck



Guest Stateroom



Guest Bath



Guest Stateroom



Guest Bath



Guest Stateroom



Guest Stateroom



Sundeck



Sundeck



Sundeck



Sundeck



Sundeck



Sundeck



Sundeck



Foredeck



Sundeck Dayhead



Foredeck















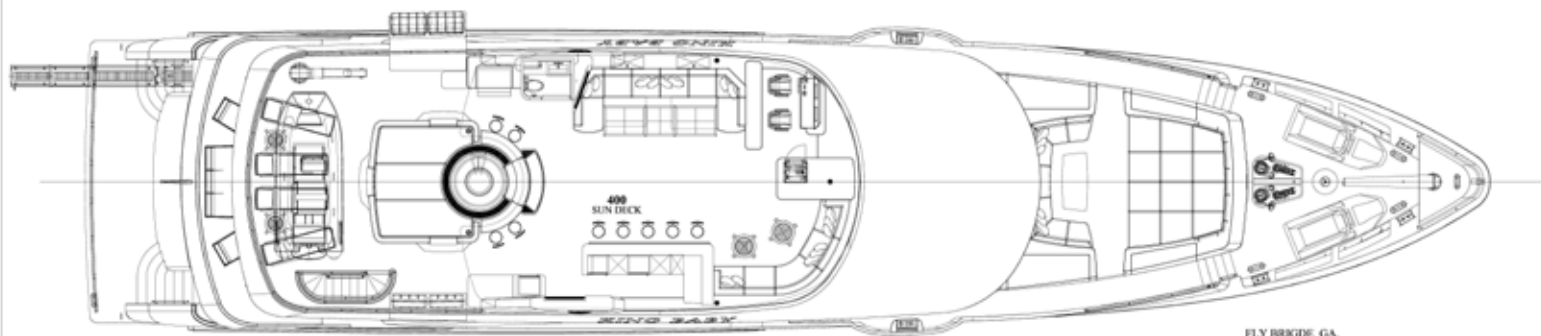

FLY BRIDGE GA.

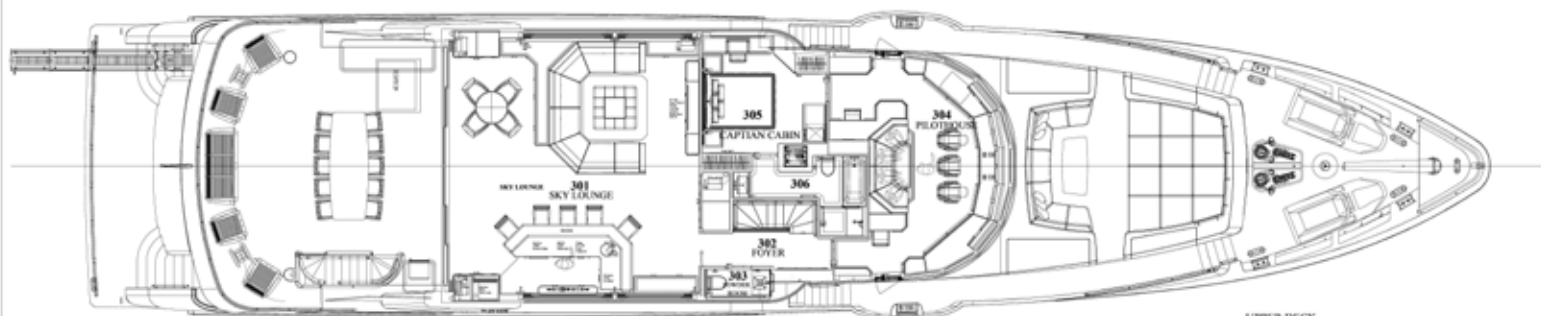

UPPER DECK

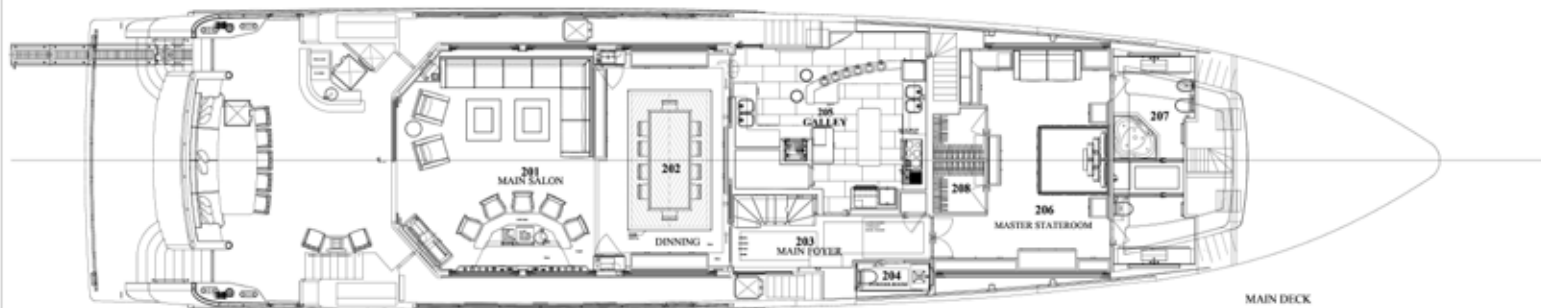

MAIN DECK

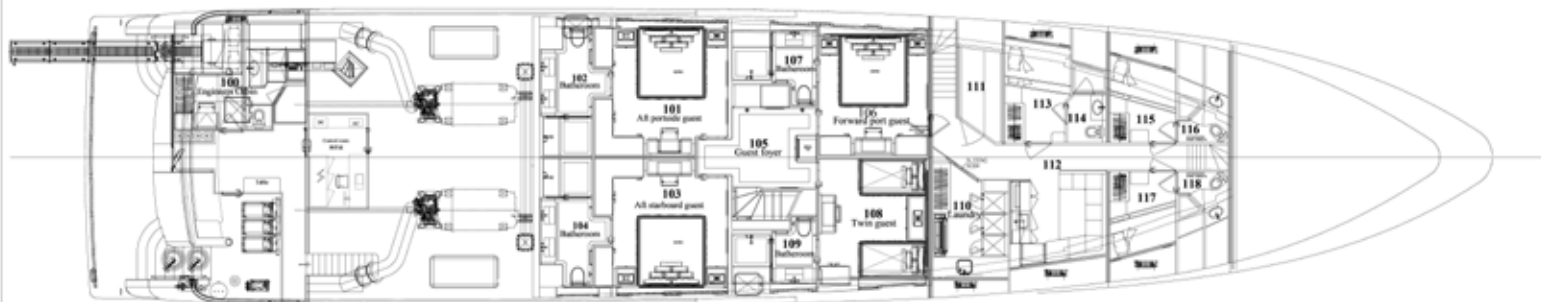

LOWER DECK

KING BABY



charter@luxurychartergroup.com

FOR ADDITIONAL INFORMATION REGARDING KING BABY

www.kingbaby-yacht.com