

An aerial photograph of a tropical island with a dense palm tree forest and a white sandy beach. The water is crystal clear, showing a vibrant turquoise color near the shore that transitions into a deep blue further out. A white catamaran with two masts is sailing in the lower right quadrant of the image. The sky is a clear, bright blue with a few wispy clouds.

DOUCE FRANCE

---





# KEY FEATURES

---

1. LARGEST SCHOONER CATAMARAN
2. GREAT DECK SPACE
3. DIVING FACILITIES ON BOARD
4. EXCLUSIVE LOCATIONS

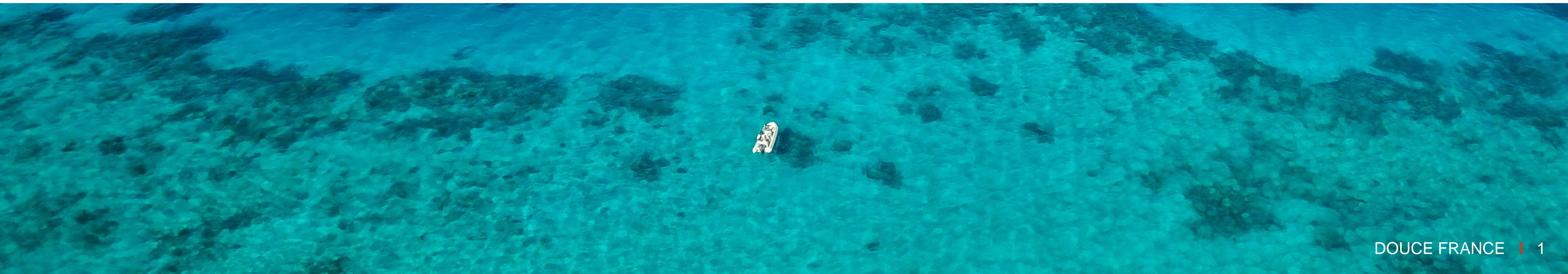





# SPECS

---

<b>NAME</b>	DOUCE FRANCE
<b>BUILDER</b>	Alumarine
<b>YEAR OF BUILD</b>	1998 (2015)
<b>LENGTH</b>	42.20 metres (138' 5")
<b>BEAM</b>	15.40 metres (50' 6")
<b>DRAFT</b>	2.5 metres (8' 2")
<b>NUMBER OF GUESTS</b>	12
<b>NUMBER OF CREW</b>	7
<b>CRUISING SPEED</b>	11 knots
<b>SPECIFIC WATER TOYS</b>	21' Zeplin semi-rigid w/ 150hp Cholamark RIB 40 HP 2 Laser Sailing Dingies Windsurf equipment 4 Sea Kayaks Water-skis (adults, slalom ski, ski's for children & for acrobatics) Wakeboard Surfboard Single Donut Snorkeling equipment Fishing equipment 8 sets scuba diving equipment w/ diving instructor as 4 x suex water scooters 3 x SUP's



# THE GENTLE GIANT

---

Sleek, sophisticated, sexy and incredibly fast, this 138ft catamaran, known as 'the gentle Giant' combines spaciousness, cleanliness, culinary excellence with the charms of a traditional sailing boat, the stability of a catamaran and the result of excellent design and construction by the world's finest craftsmen. Douce France is a famous charter yacht available in beautiful locations all over the world.

Douce France is a luxury sailing catamaran designed by Van Peteghem & Lauriot Prevost, world renowned naval architects and specialists for multihull yachts. Douce France is perfectly equipped for charter worldwide to discover the world's most beautiful and unspoiled places whilst submerged in the highest standards of luxury in the yachting industry. She is built for adventure and graces the world seas with her gentle, yet impressive, appearance.







# THE LARGEST SCHOONER CATAMARAN

---

Guests appreciate her spaciousness and intimacy, her elegance and fine line on the water. Douce France is unique and offers a guest experience that is unprecedented. With her 138 feet she's the largest schooner sailing catamaran in the world and anyone who sees her stunning looks cannot be left untouched. Guests have easy access to the sea and tenders with a fold away stairway. The aft deck is an exquisite sunbathing area or lends itself to cherish a perfect sunset over the infinite ocean. Her trampolines are exceedingly spacious, offering enough room for guests to sprawl out on and feel the sea spray as she glides along.

The teak decks are smooth and desirable to the touch and lure her guests to a variety of levels, including a towering fly bridge that embellishes the surroundings. A wet bar in the spacious cockpit offers guests a well-deserved refreshment in the shade after a swim. Douce France's beautiful interior is the essence of elegance. Furniture of Mahogany and Rosewood exudes a feel of colonial charm.



# GREAT DECK SPACE

---

Douce France offers an environment that invites long naps and serenity in an abundance of comfortable outside settings, where the natural scenery cradles the yacht. Guests have a choice of three dining areas. The spacious cockpit pleasantly shaded by the overhang of the deckhouse, the more intimate lounge for the cooler evenings or the aft deck where one can enjoy the warm breeze and dine under the starlight.

What is more relaxing than having your cocktail on the fly bridge of Douce France with a 360 degree sea view around you? Douce France also provides onboard all the necessary material for big or small game fishing. The crew will be happy to assist and instruct guests in the exciting sport of finding, hooking and reeling in one of the oceans predators









# TOYS & FACILITIES

---

Snorkelling and diving are the greatest ways to discover underwater life. Douce France is equipped with all the necessary gear for any guest to dive into the crystal blue water and start discovering this captivating world. The onboard personal diving instructor will guide the guests into the tropical reefs and diving spots. With his great experience, guests will feel safe around their instructor while they are learning more about the fauna and flora below sea level. 8 full sets of diving gear are at the charterer's disposal.

An impressive selection of water toys and activities will please every guest. Peddling through the tropical blue waters in a one or two-seated ocean kayak, guests will discover their own little paradise of unspoiled nature and wildlife. Douce France has all the equipment to explore life below the waterline snorkelling around a reef or next to a white sanded beach.

For the more active guests, Douce France carries a large selection of water sports equipment and offers activities such as wave surfing, waterskiing, sailing and windsurfing. After workouts, guests can enjoy fresh fruit salads or healthy snacks created by the chef at all times during the day to recharge their batteries for the next adventure















# FINE DINING

---

Aboard Douce France barefoot charter guests dine alfresco. This wonderful experience leaves guests tasting the skills of the world-class chef while enjoying the view. Dining on Douce France is where one will appreciate the presence of French knowledge in the art of gastronomy. Masterful creations fresh from the sea are artfully presented on Limoges china and are enhanced by a wine selection that is perhaps one of the most extensive offered on board any charter vessel.

French haute cuisine as well as Asian, Japanese, Indian, Thao or Creole preparations with fresh fish and local ingredients will leave everyone not asking for more. Based on the client's preferences, the chef will personalise every meal. A professional crew will serve comfortably seated gourmets, the finest meals prepared in a modern stainless steel galley.



# ACCOMMODATION

---

The boat is designed to accommodate 12 guests in 6 brightly lit and air conditioned staterooms. Each of them is attractively lined with pale sycamore wood. The chic linen beckons the guests to a restful night's sleep. Each 50 square foot room offers the option of either a queen double or twin single bed arrangement and also leaves sufficient room for a convertible desk or dressing table.

Every stateroom has its own spacious en-suite shower with a separate head compartment. After a sunny day on deck it is a nice feeling to get refreshed in the cooled rooms. Douce France just has all the requirements for a perfect holiday in secluded locations with a high standard of service and a welcoming crew.









# LAYOUT

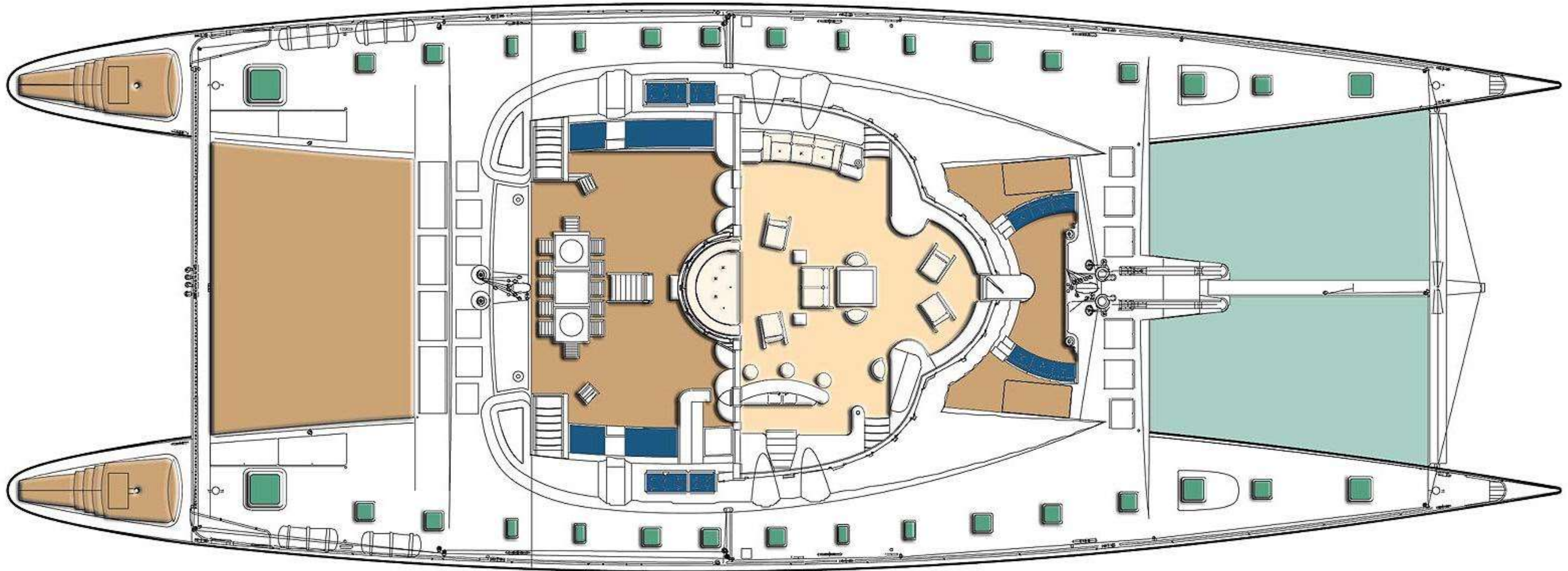



# LAYOUT

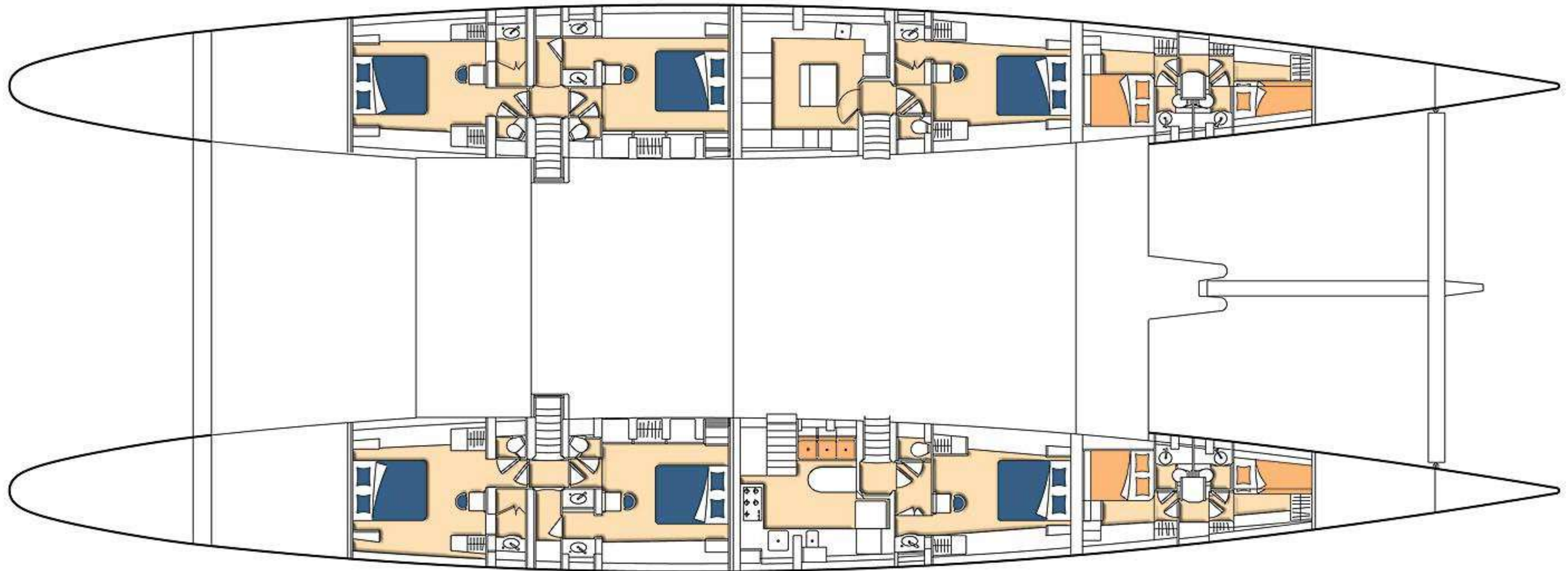









WE ARE LOOKING FORWARD TO WELCOMING YOU ON

# DOUCE FRANCE

