

Iraklis L





Iraklis L

onar



Iraklis L

Iraklis was designed and constructed by ONAR Shipping at Perama - Piraeus, Greece.

It combines traditional build quality with the finest attention to modern details.

onar



Iraklis L



Iraklis L

Onor



Iraklis L

onar



Iraklis L



Iraklis L

onar



Iraklis L

onar



Iraklis L

onar



Iraklis L

MASTER CABIN



onar

MASTER CABIN



Iraklis L

onar

VIP SUITE



Iraklis L

onar

VIP SUITE



Iraklis L

onar

GUEST CABINS



Iraklis L

onar

GUEST CABINS



Iraklis L

onar

GUEST CABINS



Iraklis L

onar

GUEST CABINS



Iraklis L

GUEST CABINS



Iraklis L

onar

GUEST CABINS



Iraklis L

onar

GUEST CABINS



Iraklis L

onar

GUEST CABINS



Iraklis L

onar



Iraklis L

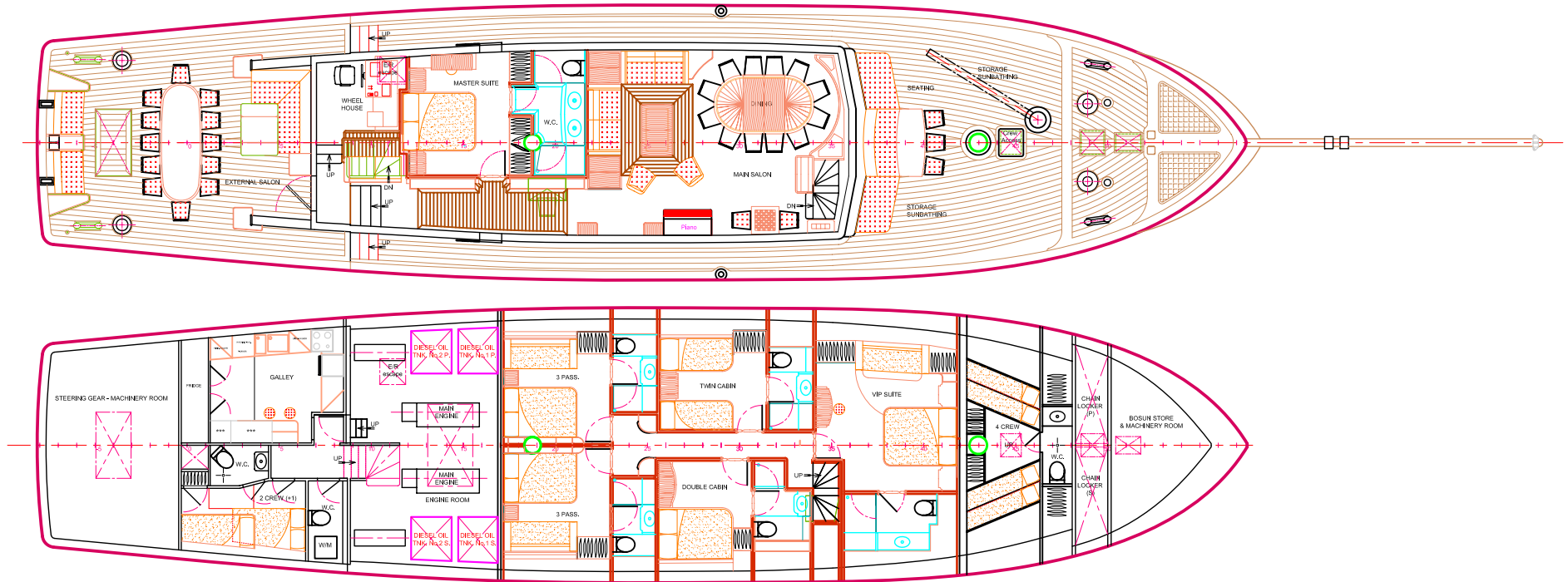

Motor Sailer "IRAKLIS L"

Built	June 2009 at Perama-Greece, Custom made by "ONAR" Ship. Co.
Class	H.R.S.
LOA	35,50 mtrs
Total Length	42,00 mtrs (including bow sprit)
Beam	7,60 mtrs
Draft	3,20 mtrs
Hull & Superstructure	Iroko
Deck	Teak
Interior	Mahogany
Displacement	240 tons
Engines	Cummins 2 x 525 HP
Speed	Cruising 12 knots & Maximum 13.8 knots
Consumption	170 ltrs/hour for propulsion engines 150 ltrs/day for generators. Fuel Capacity 8,000 ltr
Navigation Equipment	Two Radars, Two Echo sounders, Two VHF/DCS, Three GPS - chart plotters One navigation computer, Four portable VHF, Auto-pilot etc.
Sails/Rigging	Total about 500 m ² , Made by "Quantum": - Genoa 145 m ² , Staysail 80 m ² , Main staysail 120 m ² , Mizzen sail 150 m ² "Antal" self tacking systems

Water capacity	5,000 ltrs
Water makers	1 x 600 ltrs/hour & 1 x 300 ltrs/hour
Stabilizer	TRACK USA - at sea and at anchor (zero - speed)
Bow Thruster	TRACK 80 HP
Electric Power	Two generators Cummins 50 KW each One generator ONAN 32 KW
Voltage	3 80 3-phase, 220V AC, 24V DC, 12V DC
A/C	Fully air conditioned (cold & hot) individually controlled from each cabin. In addition all cabins and salon are supplied by pre-climatized fresh air .
Passengers	12 + 2 in six cabins
No. of Crew	

Accommodation: "Iraklis L" designed by **Lally Poulias**, comfortably accommodates twelve plus two guests in **six** cabins.

- One Master cabin on main deck with double bed
- One VIP cabin on lower deck with double bed and sofa
- Two cabins with one double bed and one single bed/sofa (large size)
- One cabin with double bed
- One cabin with twin single beds
- All cabins with en suite facilities, hydro jets and provided with individually controlled TV, DVD, CD, MP3, radio stereo, i-pod etc. including internet

Recreation:

- Sat TV in salon, aft deck and in all cabins (flat LCD screens 40", 32", 26", 22") each TV supplied with individual sat receivers.
- Individual DVD/CD/MP3, i-pod players in salon, aft deck and in all cabins
- One tender 5.5 mtr. with 140 HP Suzuki 4-stroke
- One jet ski Yamaha (three seats - 210 hp)
- Piano/Glavinova with karaoke and CD player at salon
- Wind surf, Scuba diving equipment & air compressor (on request)
- Water ski, Full snorkelling, Fishing equipment
- Laptop computer, Internet
- One cellular phone



CONSTRUCTION BY:

onar